

Facility Description and Information

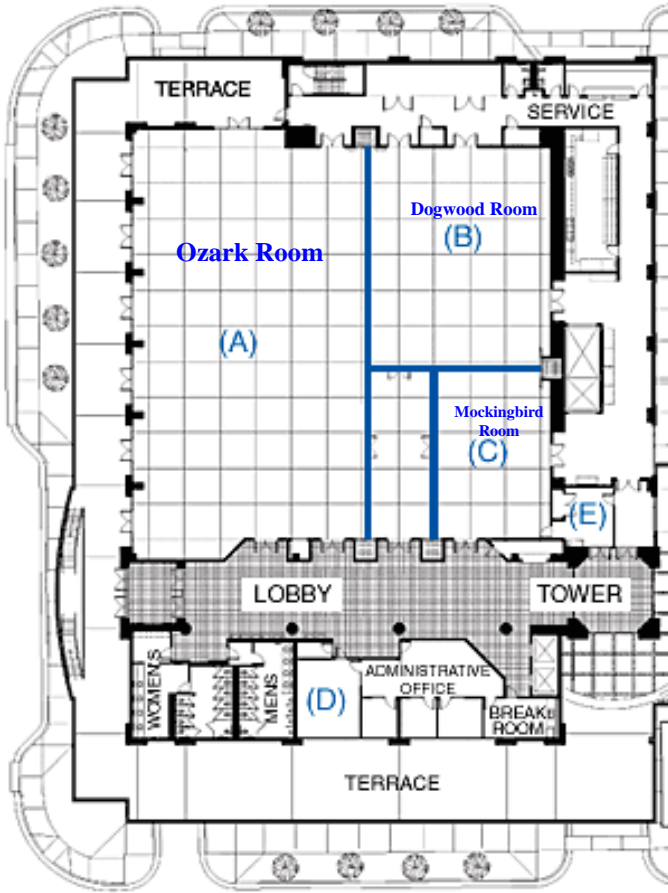

NOTE: Quantities are based on **Maximum Occupancy** (tables & chairs only)

| Razorback Room (A, B, C) 118 x 115 – 13,570 square feet | | | | | | | |
|--|---------|--------|----------|---------|---------|------|-----|
| Standing Recep | Theater | Clssrm | Crescent | Banquet | | Conf | U |
| 2500 | 1426 | 576 | 486 | 8 tops | 10 tops | N/A | N/A |
| | | | | 720 | 700 | | |
| Ozark Room (A) 66 x 120 – 7,920 square feet | | | | | | | |
| Standing Recep | Theater | Clssrm | Crescent | Rnds | | Conf | U |
| 1440 | 800 | 432 | 288 | 8 tops | 10 tops | 165 | 110 |
| | | | | 280 | 350 | | |
| Dogwood/Mockingbird Room (B,C) 52 X 110 – 5,720 square feet | | | | | | | |
| Standing Recep | Theater | Clssrm | Crescent | Rnds | | Conf | U |
| 935 | 540 | 324 | 215 | 8 Tops | 10 Tops | 175 | 175 |
| | | | | 256 | 320 | | |
| Dogwood Room (B) 52 x 62 – 3,224 square feet | | | | | | | |
| Standing Recep | Theater | Clssrm | Crescent | Rnds | | Conf | U |
| 585 | 340 | 190 | 130 | 8 Tops | 10 Tops | 110 | 110 |
| | | | | 120 | 150 | | |
| Mockingbird Room (C) 33 x 48 – 1,440 square feet | | | | | | | |
| Standing Recep | Theater | Clssrm | Crescent | Rnds | | Conf | U |
| 250 | 150 | 65 | 66 | 8 Tops | 10 Tops | 50 | 50 |
| | | | | 64 | 80 | | |
| Directors Room (D) 22 x 17.5 – 385 square feet | | | | | | | |
| Standing Recep | Theater | Clssrm | Crescent | Rnds | | Conf | U |
| 30 | N/A | N/A | N/A | N/A | | 12 | N/A |
| Hallway 19 x 48 – 912 square feet | | | | | | | |